

Technical data :	
Rated voltage	24 V DC
Rated current	500 mA
Ambient temperature range	-25...70 °C
Protection :	
Protection degree	IP67
M12 female bulkhead connector :	
Mounting type	Internal screwing
Receptacle material	CuZn, nickel-plated
Contact diameter	Ø1 mm
Contact material	CuZn, gold-plated
Accessories (included) :	
1 M16x1,5 nut, nickel-plated brass	

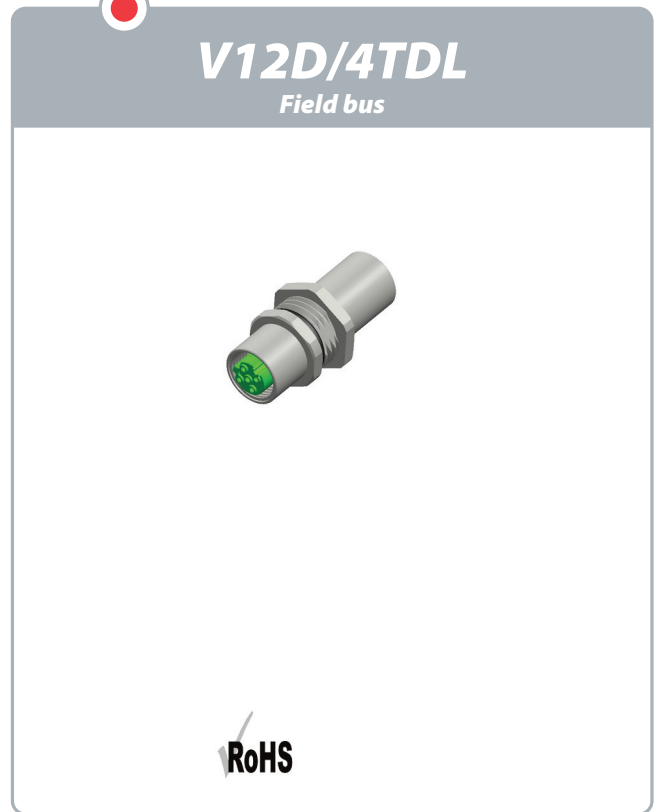

Dimensions :

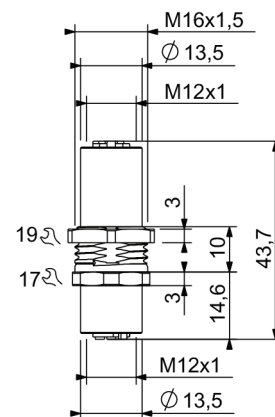

Wiring diagram :

