

**Set including :**

- 1x PTFE-coated stainless steel electrode bracket
- 1x Scratch-resistant PMMA sensing face
- 3x CHC M3-6mm zinc-plated steel screw (ISO 4762 DIN 912)
- 1x Ø4x1,5 NBR O-Ring
- 1x Ø17x2 NBR O-Ring

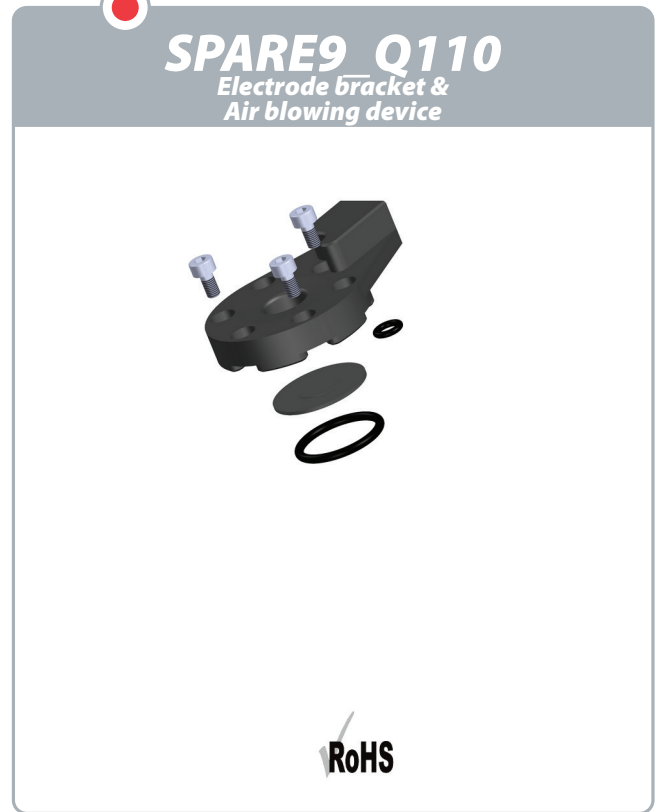

**Dimensions :**

