

Technical data :	
Rated voltage	48 V DC
Rated current	6 A
Insulation resistance	> 100 MΩ
Ambient temperature range	-25...70 °C

Protection :	
Protection degree	IP67

M23 male receptacle :	
Mounting type	External screwing
Receptacle material	CuZn, nickel-plated
Locking nut/screw material	Zamak, nickel-plated
Contact diameter	16 x Ø1 mm + 3 x Ø1,5 mm
Contact material	CuZn, pre-plated with nickel and gold-plated
Contact resistance	< 5 mΩ

Cable characteristics :	
Sheath material	PVC
Wire structure	16 x 0,50 mm ²
Conductor class	5
Sheath diameter	10,2 mm
Flame resistance according to	IEC 60332-1 (VDE 0472-804/B)

Cable length :	
L length	0,5 m
L1 length	35 mm
L2 length	135 mm

Accessories (included) :	
4 screws M3-10mm, DIN84, ISO1207	
4 nuts M3, DIN934, ISO4032	
4 lock washers, DIN 7698	
1 flat seal (NBR)	

L2319EME0055C

Industrial automation



RoHS

Dimensions :

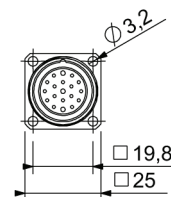
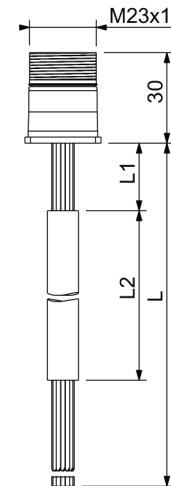

Wiring diagram :

