

| Technical data :                 |  |
|----------------------------------|--|
| Rated voltage                    | 48 V DC                                      |
| Rated current                    | 8 A  |
| Insulation resistance            | > 100 MΩ                                     |
| Ambient temperature range        | -30...80 °C                                  |
| Protection :                     |  |
| Protection degree                | IP67   |
| M23 male receptacle :            |  |
| Mounting type                    | Internal screwing                            |
| Receptacle material              | CuZn, nickel-plated                          |
| Locking nut/screw material       | Zamak, nickel-plated                         |
| Contact diameter                 | Ø1 mm  |
| Contact material                 | CuZn, pre-plated with nickel and gold-plated |
| Contact resistance               | < 5 mΩ                                       |
| Cable characteristics :          |  |
| Sheath material                  | PVC  |
| Wire structure                   | 12 x 0,50 mm <sup>2</sup>                    |
| Conductor class                  | 5  |
| Sheath diameter                  | 9 mm   |
| Flame resistance according to    | IEC 60332-1 (VDE 0472-804/B)                 |
| Cable length :                   |  |
| L length                         | 0,5 m  |
| Other length                     | On request                                   |
| Accessories (included) :         |  |
| 4 screws M3-10mm, DIN84, ISO1207 |  |
| 1 flat seal (NBR)                |  |

## L2312EM0055

Industrial automation



RoHS

Dimensions :

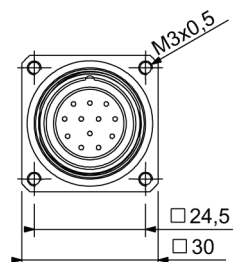
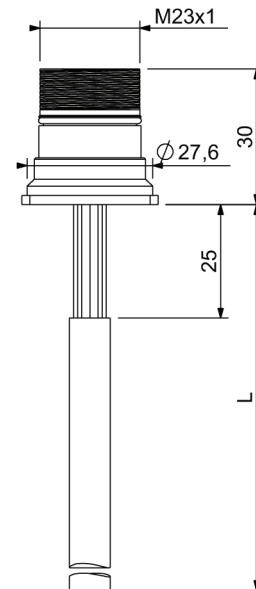

Wiring diagram :

