

Technical data :

Rated voltage	48 V AC/DC
Rated current	4 A
Insulation resistance	> 1000 MΩ
Ambient temperature range	-25...70°C

Protection :

Protection degree	IP67
-------------------	------

M12 receptacle :

Locking nut/screw material	Plastic
Contact diameter	Ø1 mm
Connection type	Screw connection (max. 1,50 mm ²)
Hood material	Plastic

L12/4TL01

Industrial automation



Dimensions :

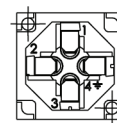
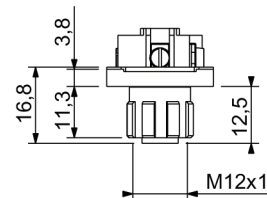
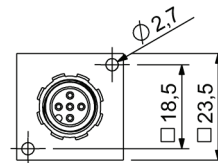

Pin assignment :

