

**Technical data :**

|                           |             |
|---------------------------|-------------|
| Output type               | PNP         |
| Function                  | NO          |
| Operating voltage         | 10...30V DC |
| Operating current         | 200 mA      |
| No-load consumption       | < 12 mA     |
| Voltage drop              | < 2 V       |
| Residual current          | < 70 µA     |
| Ambient temperature range | -25...70 °C |
| Repeatability             | < 0,1 mm    |
| Switching frequency       | 20 Hz       |

**Protection :**

|   |                        |
|---|------------------------|
| Reverse polarity protection                     |                        |
| Short-circuit protection                        |                        |
| Overload protection                             |                        |
| AC magnetic field immunity (AC welding current) |                        |
| IEC 61000-4-2 (ESD)                             | 4 kV contact / 8kV air |
| IEC 61000-4-4 (Burst)                           | 2kV / 5kHz             |
| IEC 61000-4-6 (RF conducted)                    | 3V 150kHz...80MHz      |
| Protection degree                               | IP67                   |

**Materials :**

|              |    |
|--------------|----|
| Housing      | PA |
| Sensing face | PA |

**Status indication :**

|        |            |
|--------|------------|
| Output | Yellow LED |
|--------|------------|

**Connection :**

|                  |  |
|------------------|--|
| Connector        | M12                                    |
| Cable            | PUR                                    |
| Cable length     | 0,2 m                                  |
| Cable protection | Aramid fibre (kevlar) braided sleeving |

**Accessories (not included) :**

Assembly index (SDPQ05RT, SDPQ05RS, ...)

**Remarks :**

Self-extinguishing polyamide housing (UL94-V0)

## C126302Q050311NTK

Welding environment  
Q05



**Dimensions :**

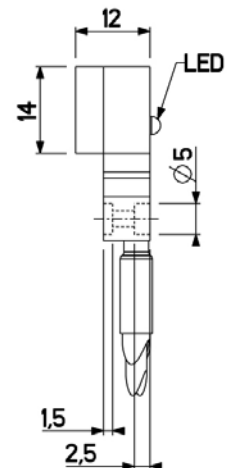
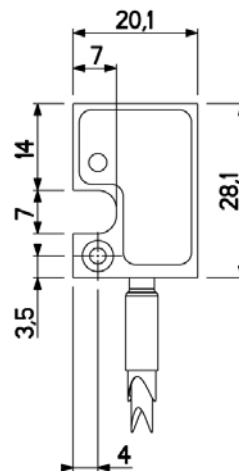
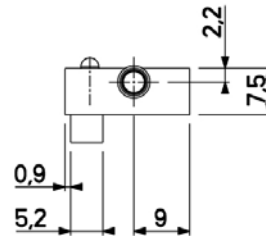

**Connection diagram :**

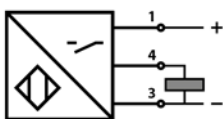

**Pin assignment :**

