

Technical data :

Rated operating distance (Sn)	8 mm (*)
Mounting mode	Flush
Output type	PNP
Function	NC
Operating voltage	10...30V DC
Operating current	200 mA
No-load consumption	< 10 mA
Voltage drop	< 2 V
Residual current	< 70 μ A
Ambient temperature range	-25...70 °C
Hysteresis	3...15 %
Repeatability	< 5 %
Switching frequency	500 Hz

Protection :

Reverse polarity protection	
Short-circuit protection	
Overload protection	
IEC 61000-4-2 (ESD)	4kV Contact / 8kV Air
IEC 61000-4-4 (Burst)	2kV / 5kHz
IEC 61000-4-6 (RF conducted)	3V 150kHz...80MHz
Protection degree	IP67

Materials :

Housing	Fiber reinforced PA
Sensing face	PA

Status indication :

Output	Yellow LED
--------	------------

Connection :

Cable	PVC (3x0,25mm ²)
Cable length	5 m

Remarks :

(*) Rated operating distance (Sn) obtained in the case of the use of a 2mm thick steel sheet placed all around the 18mm diameter sensitive face.

NB: In the case where the detector is mounted with the rear face plated on a steel sheet but without steel sheet around the sensitive face, the range Sn would then be 5,5mm.

A127355Q450821

Q45



Dimensions :

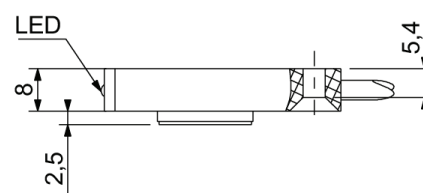
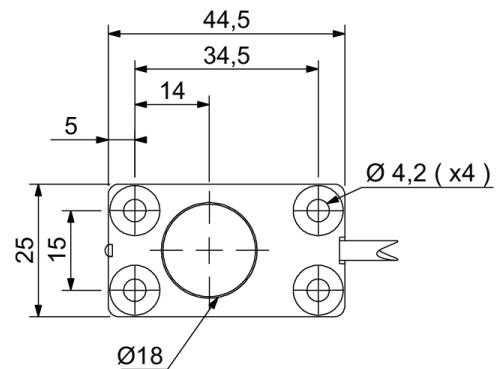

Connection diagram :

