

Technical data :

Rated operating distance (Sn)	3,5 mm
Mounting mode	Flush
Output type	PNP
Function	NO
Operating voltage	10...30V DC
Operating current	150 mA
No-load consumption	< 15 mA
Voltage drop	< 2 V
Residual current	< 70 μ A
Ambient temperature range	0...85 $^{\circ}$ C
Hysteresis	3...15 %
Repeatability	< 5 %
Switching frequency	500 Hz

Protection :

Reverse polarity protection	
Short-circuit protection	
Overload protection	
IEC 61000-4-2 (ESD)	4kV Contact / 8kV Air
IEC 61000-4-4 (Burst)	2kV / 5kHz
IEC 61000-4-6 (RF conducted)	3V 150kHz...80MHz
Protection degree	IP67

Materials :

Housing	Anodized aluminium
Sensing face	Ceramic

Status indication :

Power	Green LED
Output	Yellow LED

Connection :

Cable	PUR, halogen free (3 x 0,14 mm ²)
Cable length	3 m (0/+20 mm)

A1263M30Q240441CX

Q24



Dimensions :

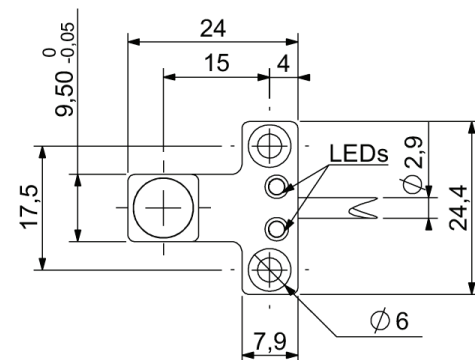
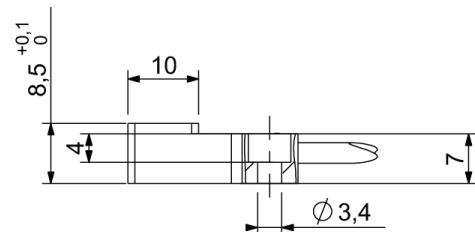

Connection diagram :

