

Technical data :

Rated operating distance (Sn)	1,5 mm
Mounting mode	Flush
Clamp opening angles: 45°...75°	
Output type	PNP
Function	NO
Operating voltage	10...30 V DC
Operating current	200 mA
No-load consumption	< 20 mA
Voltage drop	< 2 V
Residual current	< 70 µA
Ambient temperature range	-25...70 °C
Hysteresis	3...15 %
Repeatability	< 5 %
Switching frequency	1 kHz

Protection :

Reverse polarity protection	
Short-circuit protection	
Overload protection	
Protection degree	IP67

Materials :

Housing	Anodized aluminium
Sensing face	PA

Status indication :

Power	Green LED
Output S2	Red LED
Output S4	Yellow LED

Connection :

Connector	M12
Cable	PUR
Cable length	0,1 m

A126305P2545T6

Series for clamps

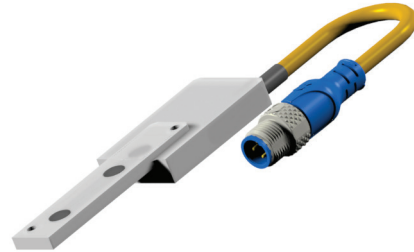

Dimensions :

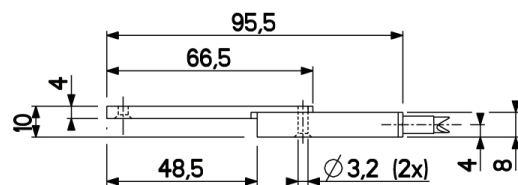
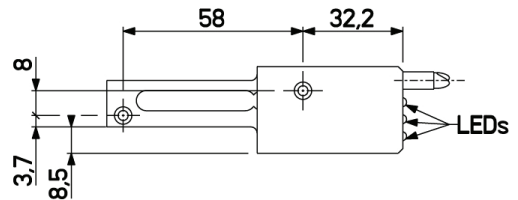

Connection diagram :

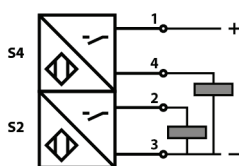

Pin assignment :

